

# POWERMAX - USA

*NCEast Project Max*

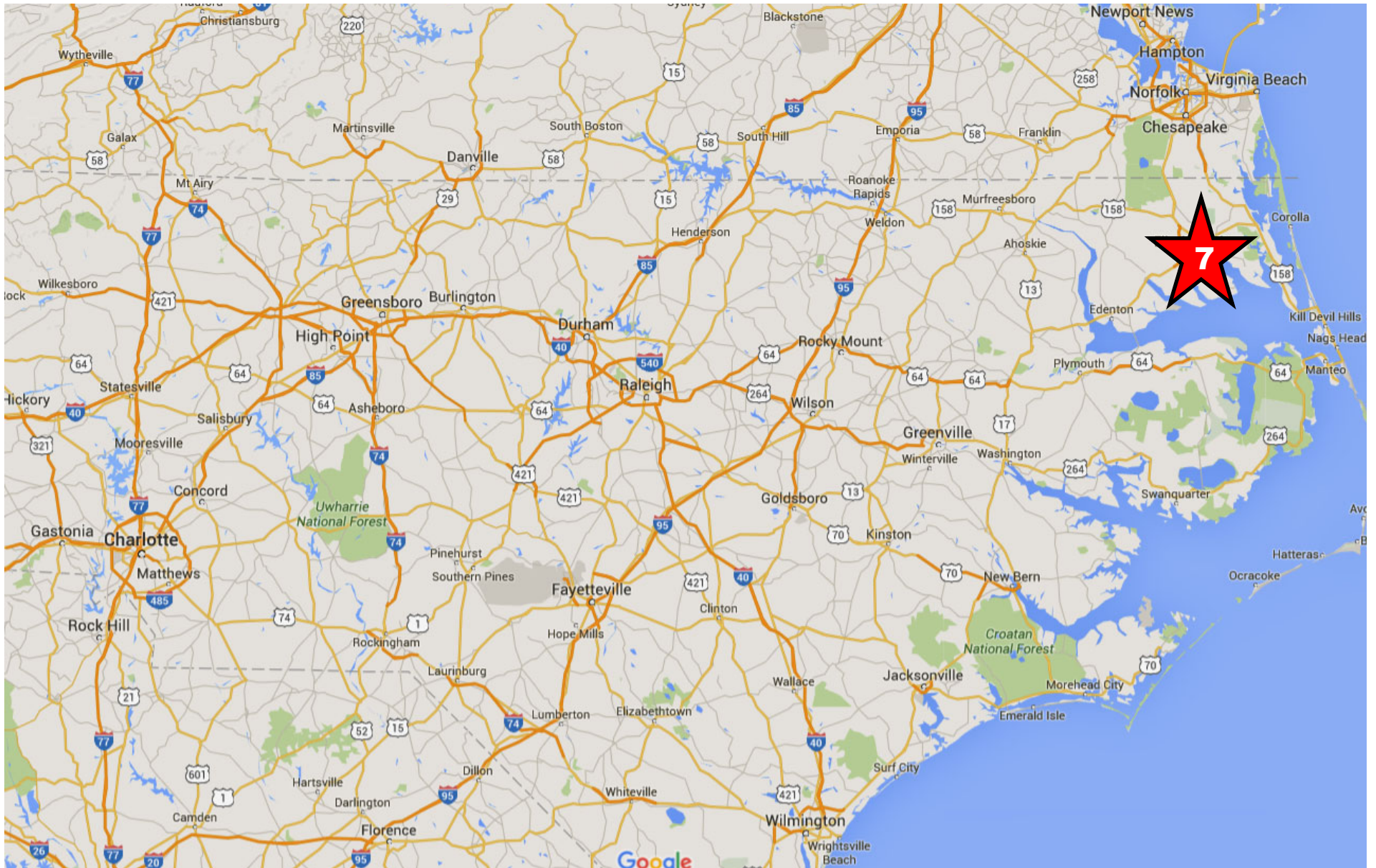





## 100 Kitty Hawk Ln

Elizabeth City, NC 27909 · Industrial For Sale

Price Not  
Disclosed



# Neany

Price	Price Not Disclosed	Year Built	1980
Property Type	Industrial	Tenancy	Single
Property Sub-type	Warehouse	Parking Ratio	1.16/1,000 SF
Building Class	C	Clear Ceiling Height	19 FT
Sale Type	Owner User	No. Dock-High Doors/Loading	4
Lot Size	8.70 AC	No. Drive In / Grade- Level Doors	3
Rentable Building Area	44,000 SF	Zoning Description	Industrial
No. Stories	1	APN / Parcel ID	892317003542
Listing ID: 11775407		Date Created: 7/22/2013	Last Updated:

## Utilities

- Water - City Water
- Sewer - City Sewer

Map of 100 Kitty Hawk Ln Elizabeth City, NC 27909





## Additional Photos

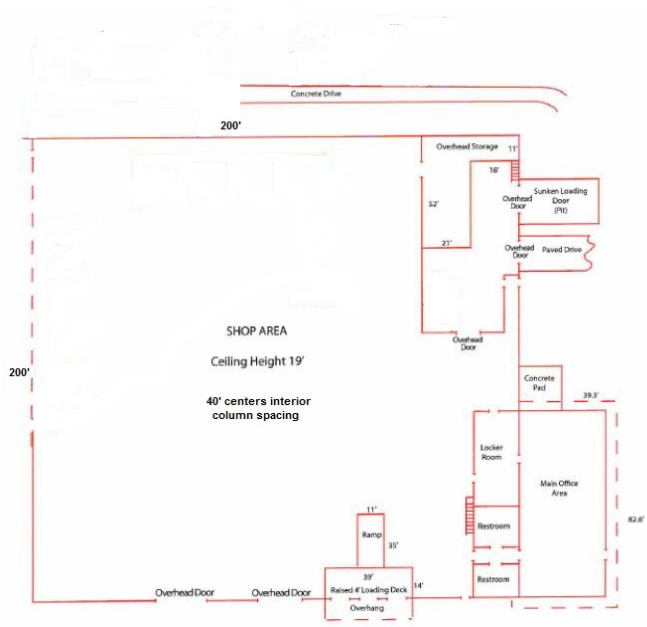

## Warehouse space plan



15' x 23' office



3 dock level doors, 2 grade level doors



1 dock well and 1 grade level door



3,300 sf office w/newly renovated interior buildout



100 Kitty Hawk Lane, Elizabeth City, NC









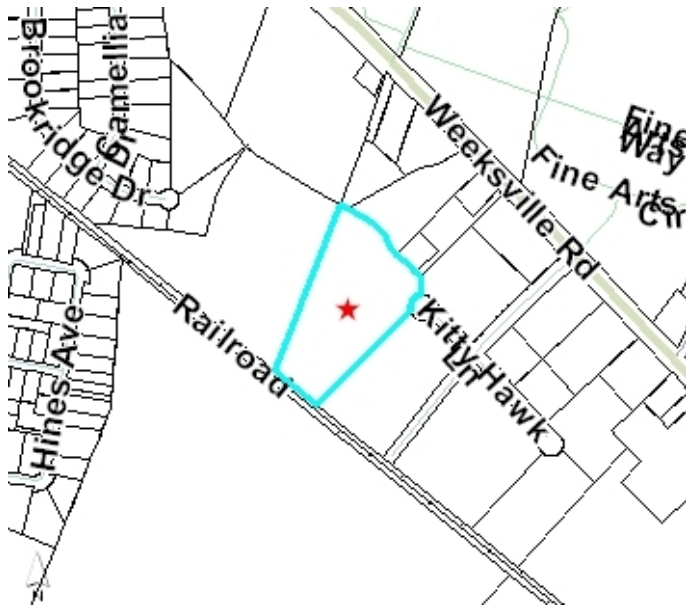

The LoopNet service and information provided therein, while believed to be accurate, are provided "as is". LoopNet disclaims any and all representations, warranties, or guarantees of any kind.