

FOR LEASE

# WAREHOUSE SPACE

5746

PEARSALL STREET

Battleboro, NC 27809



## PROPERTY FEATURES

- + Total building is +/- 383,000 square feet
- + 100,000 square feet available
  - Including approximately 5,000 square feet of office space
  - Four (4) 12' x 12' dock-high doors, four (4) 8' x 9' dock-high doors and one (1) 8' x 10' drive-in door
- + Built in 1985 & 1991
- + Located on 33.06 acres
- + Zoned Industrial (I-2)
- + 12' - 19' ceiling heights in approximately 24,000 square feet and 20' - 29' ceiling heights in approximately 71,000 square feet
- + 25' x 50' column spacing
- + 6" concrete flooring
- + 400 amps, 3-phase, 120/208 volt power
- + 400 watt metal halide and T-12 fluorescent lighting
- + Partially ESFR and partially wet sprinkler system
- + Prefabricated metal exterior construction
- + Active CSX rail spur along the western portion of the property
- + 0.60/1,000 SF parking ratio
- + Fully fenced, gated and secured
- + Signage opportunity
- + City of Rocky Mount water, sewer and natural gas services
- + Located approximately 1.5 miles from US Highway 301 and 8 miles from I-95
- + \$2.25/SF, NNN lease rate

[www.cbre.com/raleigh](http://www.cbre.com/raleigh)

**CBRE** | Raleigh

Part of the CBRE affiliate network

# FOR LEASE WAREHOUSE SPACE

5746  
PEARSALL STREET  
Battleboro, NC 27809



## FLOOR PLAN

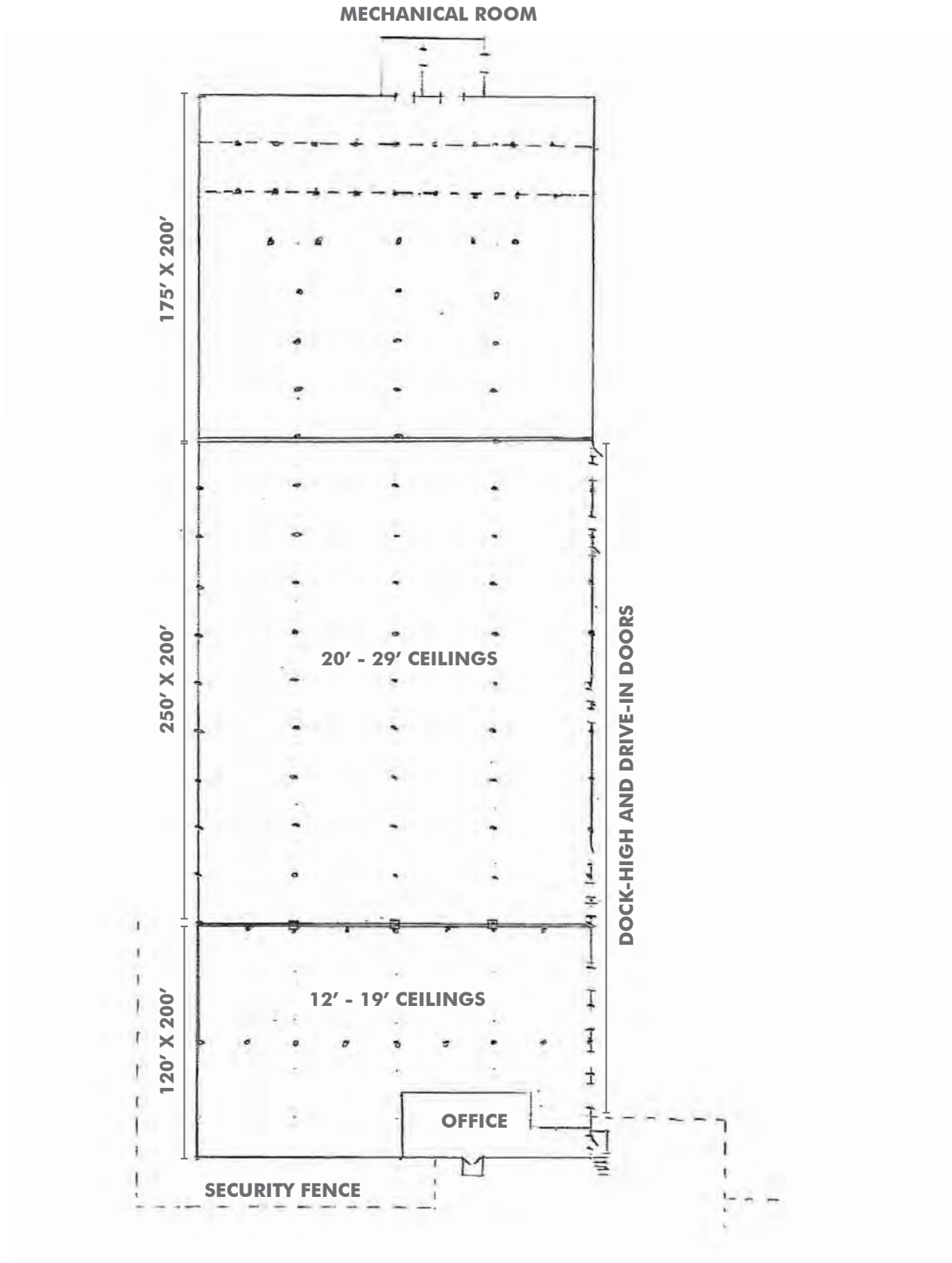

FOR LEASE  
**WAREHOUSE SPACE**

**5746**  
**PEARSALL STREET**  
Battleboro, NC 27809



**PROPERTY PHOTOS**



# FOR LEASE WAREHOUSE SPACE

5746  
PEARSALL STREET  
Battleboro, NC 27809

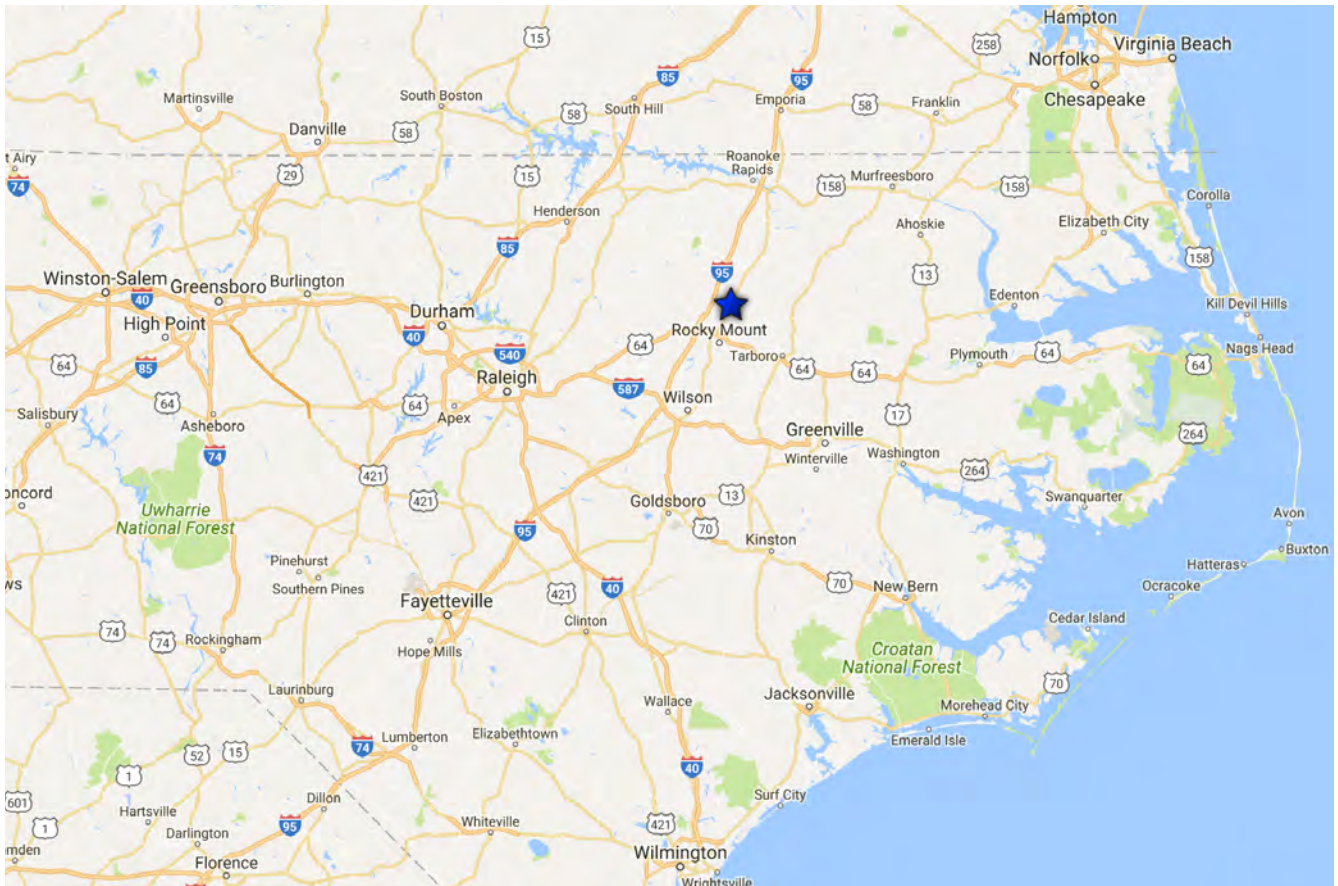

# FOR LEASE WAREHOUSE SPACE

5746  
PEARSALL STREET  
Battleboro, NC 27809



- + US Highway 301 ~ 1.5 miles
- + I-95 ~ 8 miles
- + RDU International Airport ~ 77 miles
- + Norfolk International Airport ~ 129 miles
- + PTI Airport ~ 139 miles
- + Port of Norfolk ~ 125 miles
- + Port of Morehead City ~ 129 miles
- + Port of Wilmington ~ 156 miles



## CONTACT US

### BRYAN EVERETT, SIOR

Senior Vice President  
+1 919 831 8184  
bryan.everett@cbre-raleigh.com

© 2017 CB Richard Ellis - Raleigh LLC. The information contained in this document has been obtained from sources believed reliable. While CB Richard Ellis - Raleigh LLC does not doubt its accuracy, CB Richard Ellis - Raleigh LLC has not verified it and makes no guarantee, warranty or representation about it. It is your responsibility to independently confirm its accuracy and completeness. Any projections, opinions, assumptions or estimates used are for example only and do not represent the current or future performance of the property. The value of this transaction to you depends on tax and other factors which should be evaluated by your tax, financial and legal advisors. You and your advisors should conduct a careful, independent investigation of the property to determine to your satisfaction the suitability of the property for your needs.

Photos herein are the property of their respective owners and use of these images without the express written consent of the owner is prohibited.

[www.cbre.com/raleigh](http://www.cbre.com/raleigh)

**CBRE** | Raleigh

Part of the CBRE affiliate network